



INSTRUCTION MANUAL

CM18 MOD1/ CM18 MOD1 DST

⚠ WARNING !!

- Adult supervision required.
- Always wear eye protection when using this product.
- Misuse or careless handling of this product may cause injury.
- May be hazardous up to 50 meters.
- This product is intended for users 18 years or older.
- Read all instructions before using this product.
- The buyer and the user of this product shall adhere to all local laws regulating the usage and the ownership of airsoft guns.

FIRING MODE & SAFETY

⚠ CAUTION

1. Please select a quality battery with the CE approval to avoid any unnecessary damage on the product.
2. Please use either a 8.4V or 9.6V battery. If a different voltage is used, it may damage the product.
3. Remove the battery from the product when it is not in use.
4. Do not wet or incinerate the battery. Do not deform the terminal.



SAFETY ON
The trigger cannot be pulled



SEMI AUTO
Single shot



FULL AUTO
Automatic firing

BATTERY SETTING

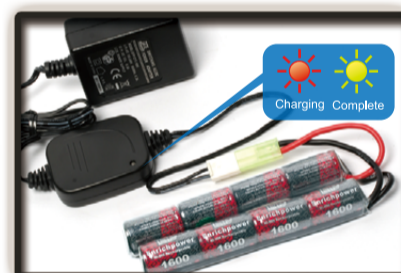

1. Charge up the battery.
2. Charging will be completed after 3 hours.

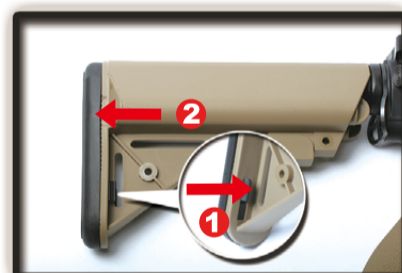

1. Push the butt plate lock (both sides)
2. Pull out the butt plate.

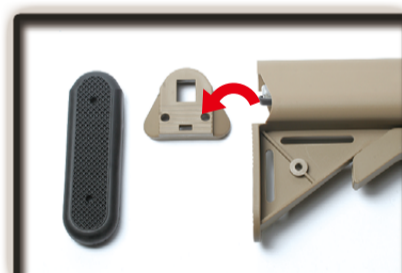

Take off the cover.

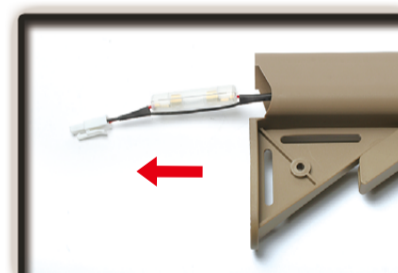

Pull out the wire connector.

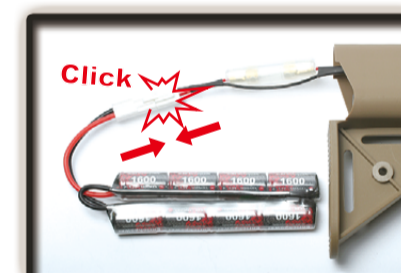

Connect battery plug with the connector until you heard a click sound.

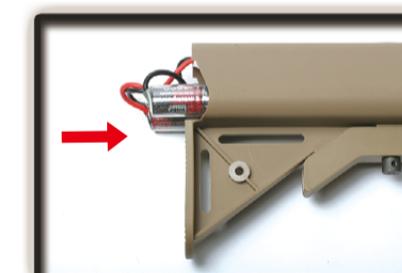

Insert the battery into stock.

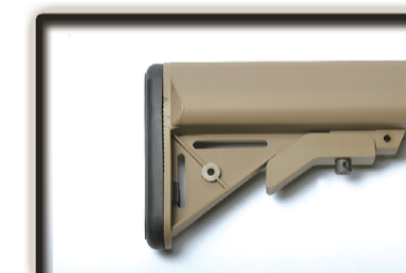

Reinstall the battery cover and butt plate.

SETTING MAGAZINE

⚠ CAUTION

It is strongly recommended to only use G&G BB pellets. Using low quality BB pellets will shorten product life span and void product warranty.

Magazine Style 420R BB Loader [Optional Parts]

Model No. G-08-100-1



Load G&G 5.95mm BB pellets into the magazine.



Insert the magazine until you heard a click sound.

HOP-UP ADJUSTMENT

⚠ CAUTION

Do not catch your fingers in the dummy bolt. Never hold the gun sideways as the BB pellets will curve right or left.



Turn to **Normal** Turn to **Hop**

- Too much Hop-up. (Turn the adjust lever toward Normal)
- Best Position. ○
- Not enough Hop-up. (Turn the adjusting lever toward Hop) or Too much Hop-up. (Turn the adjusting lever toward Normal)



INSTRUCTION MANUAL

CM18 MOD1/ CM18 MOD1 DST



TOP FIVE
FUTURE INNOVATION
FINEST QUALITY
FAST SERVICE
FREE ITEMS
FAIR PRICE



WARNING !!

- Adult supervision required.
- Always wear eye protection when using this product.
- Misuse or careless handling of this product may cause injury.
- May be hazardous up to 50 meters.

- This product is intended for users 18 years or older.
- Read all instructions before using this product.
- The buyer and the user of this product shall adhere to all local laws regulating the usage and the ownership of airsoft guns.

RETRACTABLE CRANE STOCK

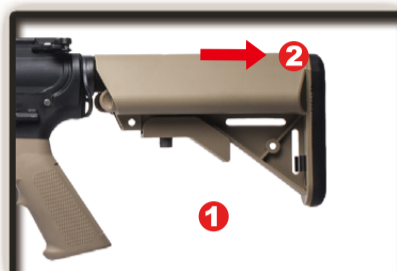

Press the stock release lever to unlock.

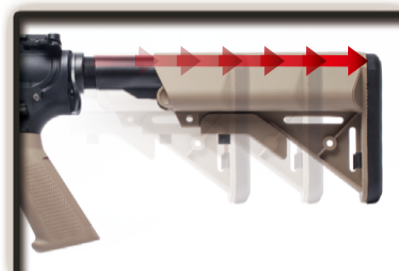

Adjust the position (6 positions).

MAINTENANCE



Remove the magazine.

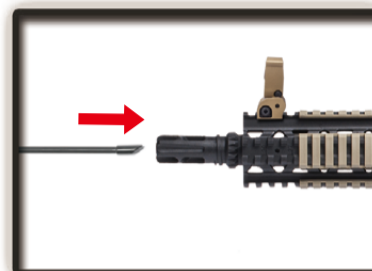

Return the hop up dial to normal position and insert the cleaning rod from the lead edge of the inner barrel.

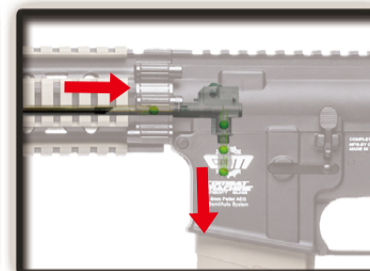

Be sure to have the rod facing down and reaching to the end. Remove clogged pellets.

TROUBLE SHOOTING



Use a screwdriver to adjust the screw at the bottom of the grip.



Check the wire set contact with the motor.

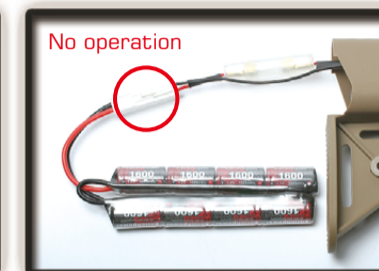

Check the battery and connector.

MOVABLE PARTS



Remove the Ladder Rail Panel.



Install the grip. (Optional)

FRONT SIGHT ADJUSTMENT

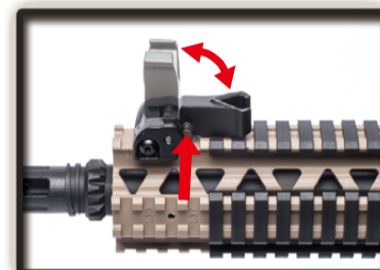

Hold down the button to fold the front sight.

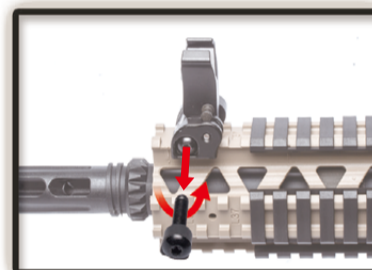

Turn the screw counterclockwise to take off the screw.



Remove the front sight off your G&G gun.

REAR SIGHT ADJUSTMENT

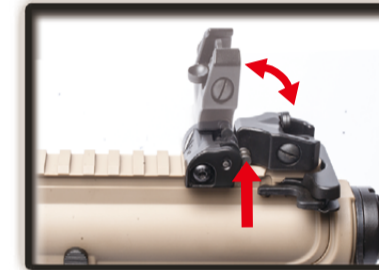

Hold down the button to fold the rear sight.

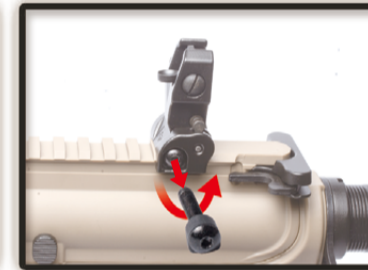

Turn the screw counterclockwise to take off the screw.

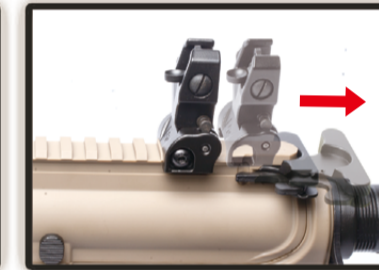

Pull the charging handle and remove the rear sight off your G&G gun.

PARTS LIST

- CM18 MOD1-01** Flash Suppressor
CM18 MOD1-02 Rail System
CM18 MOD1-03 Ladder Rail Panel x 4
CM18 MOD1-04 Outer Barrel Set
CM18 MOD1-05 Hop Up Set
CM18 MOD1-06 Delta Ring
CM18 MOD1-07 Inner Barrel
CM18 MOD1-08 Upper Receiver Set
CM18 MOD1-09 Charging Handle Set
CM18 MOD1-10 Front Frame Lock Pin Set
CM18 MOD1-11 Bolt Catch Set
CM18 MOD1-12 Selector Lever Set
CM18 MOD1-13 Magazine Catch Set
CM18 MOD1-14 Sling Swivel Mount

- CM18 MOD1-15** Enhanced Rod Set
CM18 MOD1-16 Magazine
CM18 MOD1-17 Lower Receiver Set
CM18 MOD1-18 Trigger Guard Set
CM18 MOD1-19 Rear Frame Lock Pin Set
CM18 MOD1-20 Grip Set
CM18 MOD1-21 Motor
CM18 MOD1-22 Grip Bottom Set
CM18 MOD1-23 Crane Stock Set
CM18 MOD1-24 Gear Box Set
CM18 MOD1-25 Wire
CM18 MOD1-26 Folding Front Sight
CM18 MOD1-27 Folding Rear Sight

- The grouped parts may all be purchased from the G&G Support Department.

- E-Mail: support@guay2.com

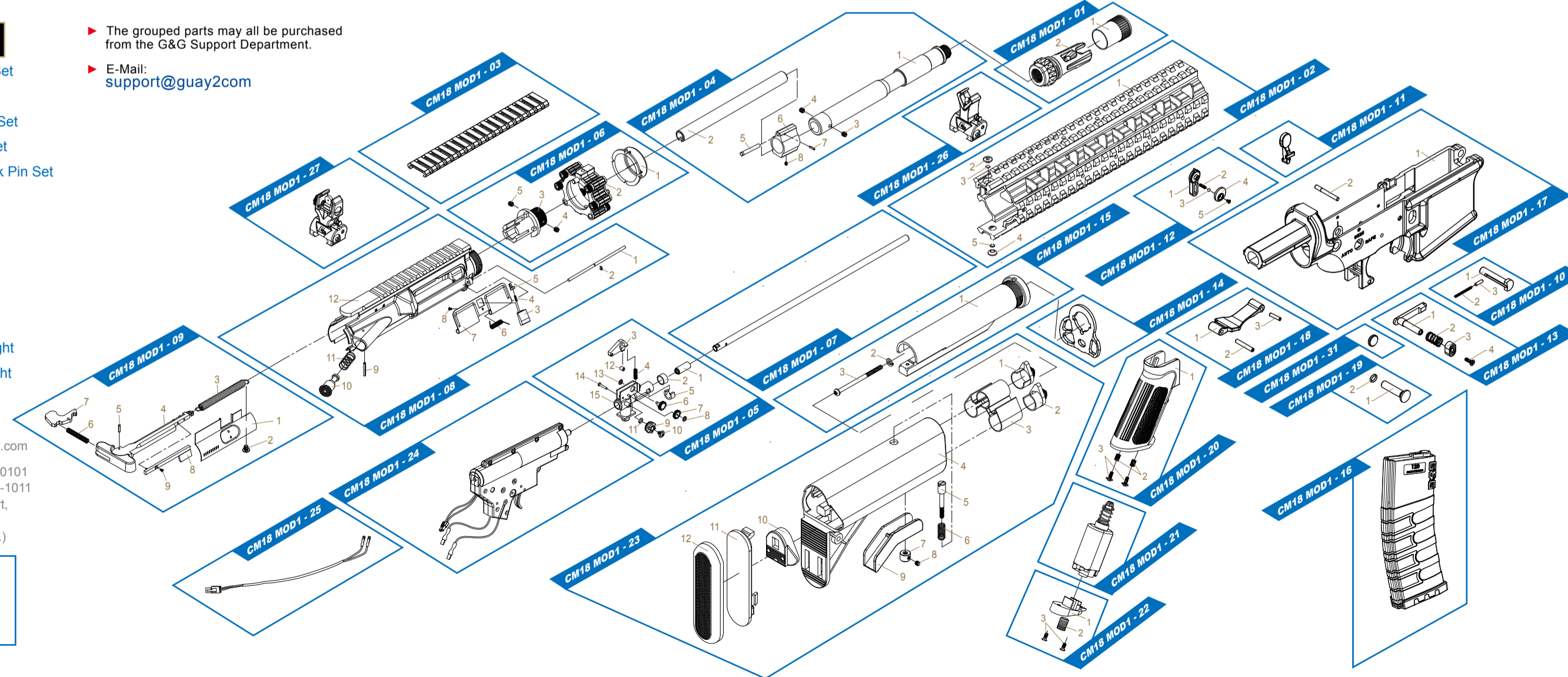

TAIWAN

Sales Dept. | sales@guay2.com , b2b@guay2.com
Technology Support Dept. | support@guay2.com
PR Dept. | pr@guay2.com

Chang Hua Headquarter
Tel : +886-4-798-9000 Fax : +886-4-798-9900
No.999, Zhonghua Rd. Shengang Township,
Changhua County 50955, Taiwan (R.O.C.)

Taipei
Tel : +886-2-2692-2000 Fax : +886-2-2692-4000
11F-3., No.27, Lane 169, Kangning St. Shijr City,
Taipei County 22180, Taiwan (R.O.C.)

U.S.A.

E-mail | sales101@guay2.com
Los Angeles
Tel : +1-626-581-0101
Fax : +1-626-581-1011
1122 Coiner Court,
City of Industry,
CA 91748 (U.S.A.)

Dealer